

# PERIMETER OFFICE PLAN

1600 SMALLMAN ST  
3RD FLOOR  
PITTSBURGH, PA

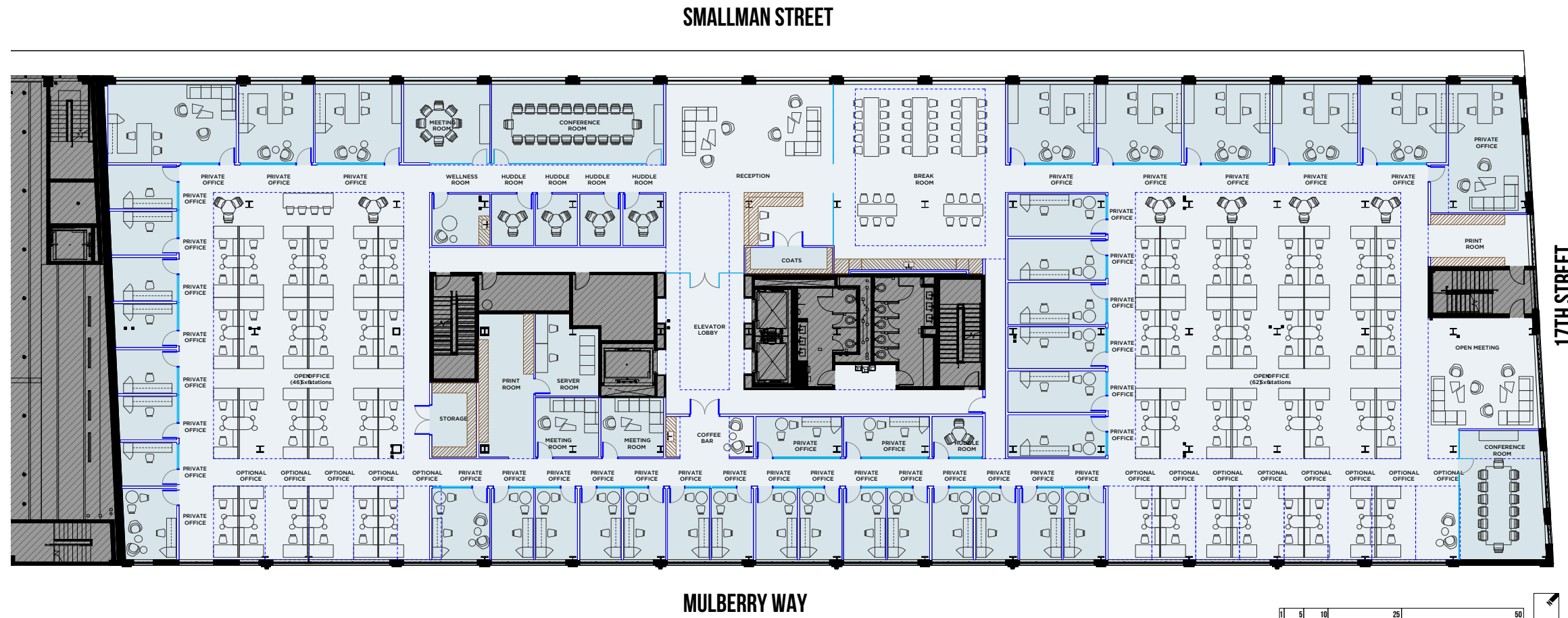

**PLANTOTALS**

SPACE	SF	#
LARGEOFFICE	450	2
MEDIOFFICE	325	7
STANDARDOFFICE	150	31
WORKSTATION	30	108
RECEPTION	950	1
CONFERENCE	650	2
MEETING	325	3
PRINT ROOM	300	2
BREAKROOM	1000	1
SERVERROOM	300	1
OPENMEETING	600	1
HUDDLE	100	5
WELLNESS	150	1

**30,150 RSF / 148 SEATS**  
**204 SF PER PERSON**

**JASON STEWART**  
Office Leasing  
Managing Director  
jason.stewart@am.jll.com  
+1 412 208 1402

**JACKIE BEZEK**  
Office Leasing  
Vice President  
jackie.bezek@am.jll.com  
+1 412 208 1413

